

Hermetic stainless steel Single Point Platform Size up to 800x1200 mm



Wash Down Applications

SSH is the right choice for the food or pharmaceutical industry where daily wash down is required. It provides best weighing performance in a hermetically sealed stainless steel load cell. Thus it is ideal for stainless steel scales or general weighing applications where the highest grade of IP protection and corrosion resistance is required.



Off-Center compensation

One load cell can be used to support a weighing platform and, due to the off-center load compensation, the SSH will weigh within tolerance regardless of load application point.



Highest Robustness

SSH is an extremely robust single point load cell suitable for almost all industrial environments. It allows 50% static overload without compromising the weighing performance.



SSH Hermetic Single Point Load Cell

The SSH load cell features:

- Off-center load compensation (R76)
- OIML R60 C3 approval (200 - 1000kg)
- up to 800x1200 mm platform size
- IP68 protection class
- Stainless Steel
- 50 - 1000kg capacity range

The SSH is the ideal solution for floor scales and packaging and process weighing where a hermetically sealed stainless steel load cell is required for harsh chemical and washdown environments. Due to the low profile the integration into any system is easy. The broad capacity range and large platform size allows wide application in industrial weighing applications.

SSH Load Cell Specifications

Parameter	unit of measure	Specification						
Model No.		SSH						
Rated Capacity (R.C.)	kg (lb, nominal)	50 (110)	100 (220)	200 (440)	300 (660)	500 (1100)	1000 (2200)	
Rated Output	mV/V @R.C.	2 ± 0.2						
Zero load Output	%R.C.	≤ 1						
Combined Error (1)(2)	%R.C.	≤ 0.0018						
Repeatability Error	%A.L. (3)	≤ 0.01						
Creep, 30 minute	%A.L.	≤ 0.0167						
Min. Dead Load Output Return (DR), 30 min	%A.L.	≤ 0.0167						
Temperature Effect on	Min. Dead load Output	%R.C./°C (./°F) ≤ 0.002 (0.001)						
	Sensitivity (2)	%A.L./°C (./°F) ≤ 0.0009 (0.0005)						
Temperature Range	Compensated	°C (°F) -10 ~ +40 (+14 ~ +104)						
	Operating	-40 ~ +65 (-40 ~ +150)						
	Safe Storage	-40 ~ +80 (-40 ~ +176)						
OIML / European Approval (4)	OIML Cert. No.	R60/2000-NL1-09.-13						
	European Cert. No.	TC7648						
	Class	C3						
	nmax	3000						
	Y	10000						
	PLC	0.7						
	Humidity Symbol	CH						
	Min. dead load	kg (lb)	0(0)					
	Z		3000					
Excitation Voltage	Recommended	V AC/DC 5~15						
	Max.	20						
Terminal Resistance	Excitation	Ω 381 ± 4						
	Output	350 ± 1						
Insulation Resistance @50VDC	MΩ	> 5000						
Breakdown Voltage	V AC	> 500						
Material	Spring Element	stainless steel						
	Enclosure	stainless steel						
	Cable entry fitting	stainless steel						
	Cable	PVC						
Protection	Type	welded						
	IP Rating	IP68 / IP69K						
	NEMA Rating	NEMA 6/6P						
Load Limit	Safe	%R.C. 150						
	Ultimate	300						
Safe Dynamic Load	%R.C.	70						
Fatigue Life	cycles @R.C.	> 1000000						
Direction of Loading		compression						
Deflection @ R.C., nominal	mm (in)	0.3 typ (0.012 typ)						
Weight, nominal	kg (lb)	1.5 (3.3)				2 (4.5)		
Cable Length	m (ft)	2.5 (8.3); 6 (20)						
Barometric Pressure Effect on Zero Load Output	kg/kPa (lb/in.Hg)	none						
Safe Side Load	%R.C.	100						
Overload Protection		none						
Mounting Screw	Grade	12.9						
	Size/thread	mm (in)	M8			M14		
	Engaged Length	mm (in)	20 (0.8)					
	Torque, nominal	N.m (ft-lb)	20 (15)	30 (22)			98 (72)	
Max Platter Size	cm x cm (in x in)	50x50 (19.7x19.7)			60x80 (23.6x31.5)		80x120 (31.5x47.3)	
Off Center Load Error @33%R.C.	%A.L./cm (./in)	0.004 (0.01)			0.0028 (0.0007)		0.0019 (0.005)	

(1) Error due to the combined effect of non-linearity and hysteresis

(2) Typical values only. The sum of errors due to Combined Error and Temperature Effect on Sensitivity comply with the requirements of OIML R60 and NIST HB44.

(3) A.L. = Applied Load

(4) See certificate for complete information.



SSH 50-500kg Load Cell Dimensional Drawings mm [inch]

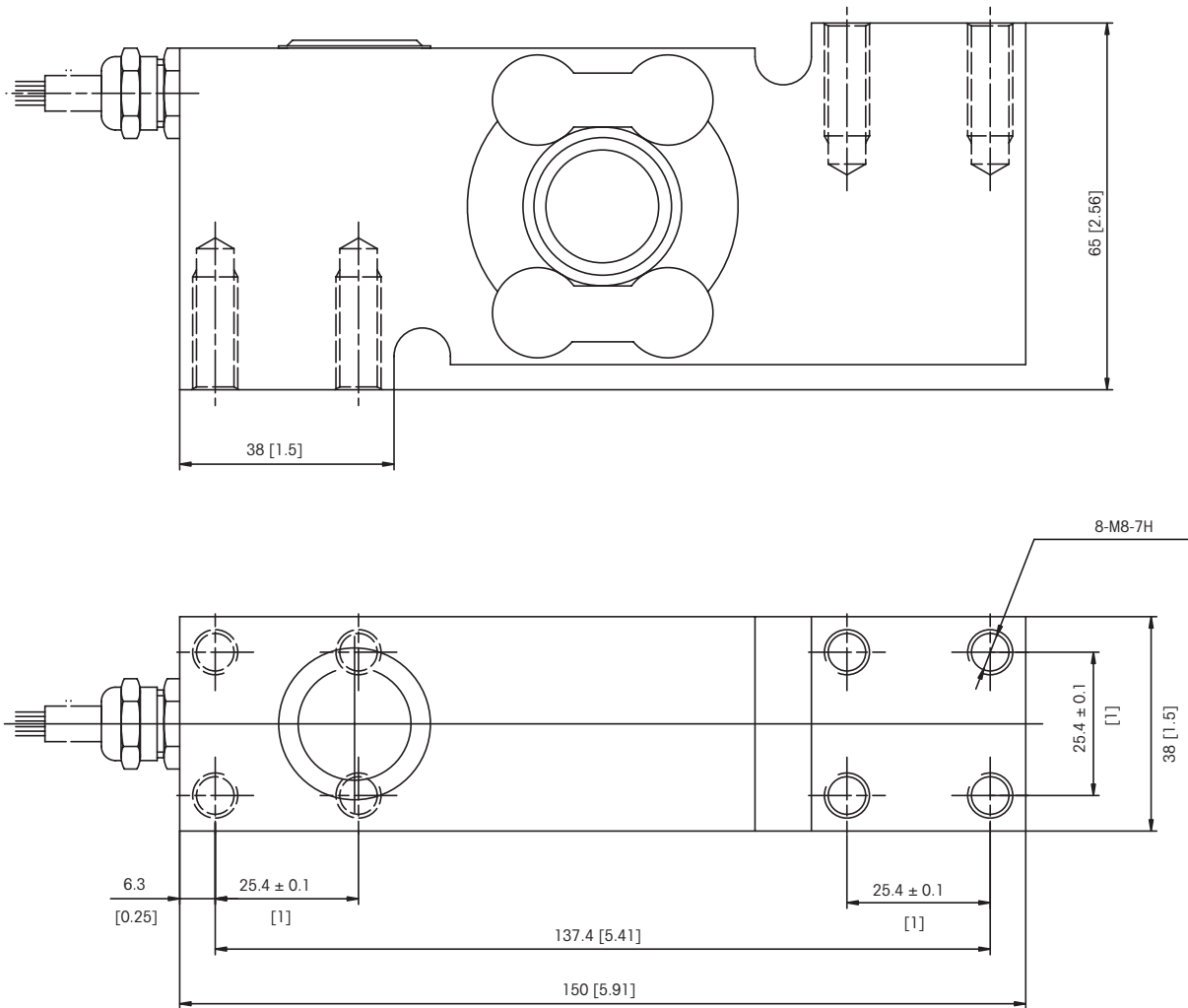

SSH 1000kg Load Cell Dimensional Drawings mm [inch]

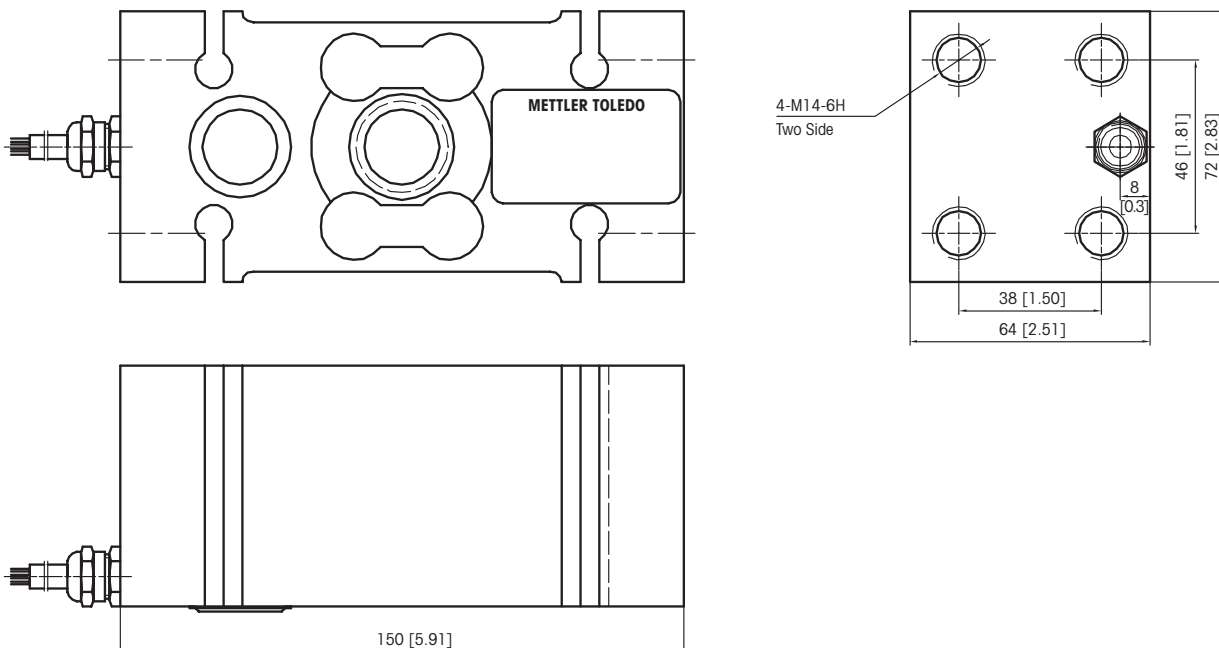

SSH Load Cell Order Information

Description	Item No.
Load Cell SSH-50kg – 2.5M	71209634
Load Cell SSH-100kg – 2.5M	71209625
Load Cell SSH-200kg – 2.5M	71209643
Load Cell SSH-500kg – 2.5M	71209644
Load Cell SSH-1000kg – 2.5M	71209937
Load Cell SSH-50kg – 6M	72208581
Load Cell SSH-100kg – 6M	72208582
Load Cell SSH-200kg – 6M	72208583
Load Cell SSH-500kg – 6M	72208584
Load Cell SSH-1000kg – 6M	72208585

Bolded entries are stocked

SSH Load Cell Cable Colours

Colour	Function
Green	+ Excitation
Black	- Excitation
White	+ Signal
Red	- Signal
Yellow	+ Sense
Blue	- Sense
Yellow (Long)	Shield

Full Connectivity

METTLER TOLEDO supplies various data communication interfaces that enable our sensors and instruments to communicate with your PLC, MES, or ERP systems.



Weighing Electronics

METTLER TOLEDO offers a complete family of electronics from simple weighing to application solutions for filling, stock control, batching, formulation, counting, and checkweighing.



METTLER TOLEDO Service

Our extensive service network is among the best in the world and ensures maximum availability and service life of your product.



Mettler-Toledo AG
Industrial Division
CH-8606 Nänikon, Switzerland
Tel. + 41 44 944 22 11

Local contact: www.mt.com/contacts

Subject to technical changes
© 07/2022 Mettler-Toledo AG
MTSI 44099846

www.mt.com

For more information